

B Series

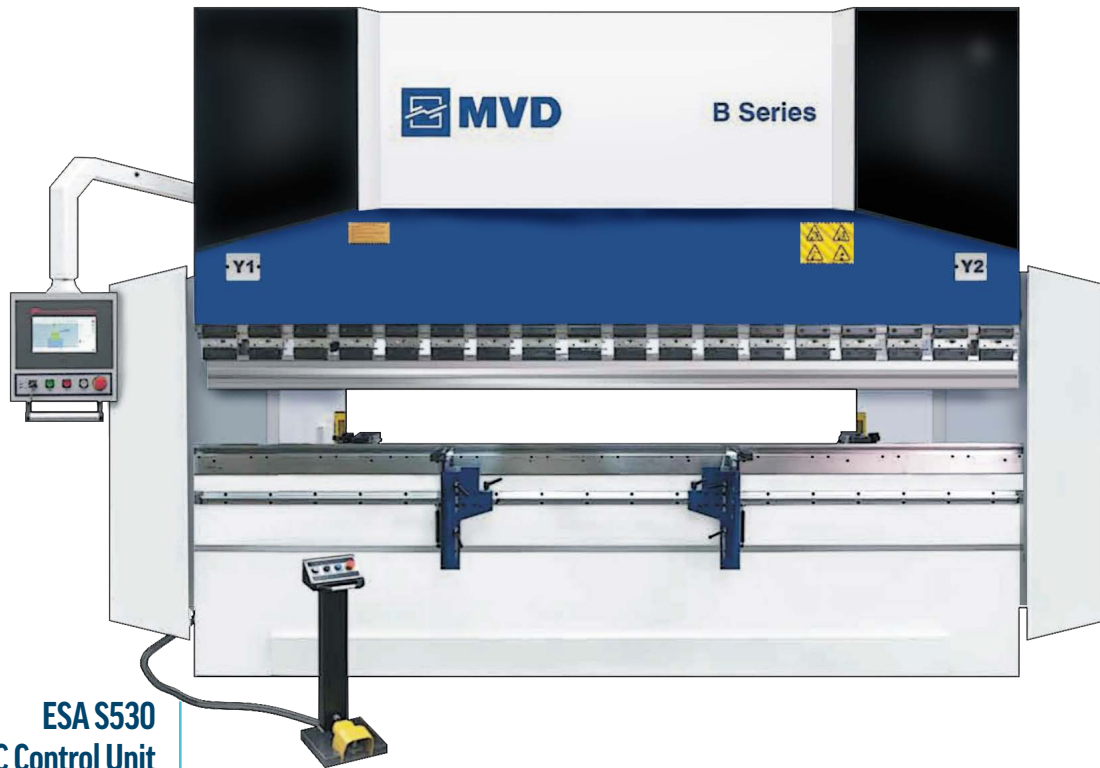

**ESA S530
CNC Control Unit**
7" Color
2D Graphic Screen

Standard Features

1. Y1,Y2,X CNC 3 Axes
2. **260mm Stroke, 410mm Throat Depth**
3. **ESA S630** CNC Control Unit
4. $\pm 0,03$ accuracy **SERVO motorized back gauge**
X=750mm
5. **Quick clamp Promecam** punch tool holder
6. **Sliding front sheet support arms**
7. MVD special narrow bottom table (European type)
8. **GIVI** optic linear scales
9. Standard punch tools (H: 67, 85°, R:08)
10. Standard die tools (60x60mm, 4 Vee
V=16-22-35-50mm, 85°, H:60)
11. LED illumination on RAM

Optional Features

1. X to 2-4-6-8 axis back gauge options
2. Wide bottom table for Multi Vee dies.
3. Anti-deflection crowning with original Wila wedges
4. AKAS or DSP front laser safety systems
5. Additional back gauge fingers
6. Front laser safety



Standard

Front sheet support arms



Standard

Optic linear scales
(0,005mm precision)



Standard

Quick clamp Promecam
Punch tool holder

410 mm Throat

Stroke
260 mm

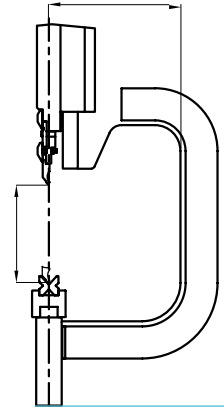

B-Series - Technical Specifications

B Bending Force	Bend- ing Length	Distance between columns	Stroke	Daylight	Throat	Table Height	Machine Dimensions			Speed			Oil tank	Weight	Main motor
	A	B	C	J	D	E	Length x Width x Height (L x W x H)			Ap- proach Speed	Return Speed	Bending Speed	Lt	kg	kW
	mm	mm	mm	mm	mm	mm	mm			mm/s	mm/s	mm/s			
B40	1250	1100	260	465	410	880	3060	2080	2820	150	120	10	95	3500	4
	2100	1600	260	465	410	870	3660	2175	2905	160	135	10	170	4560	5,5
B60	2600	2150	260	465	410	890	4210	2175	2905	160	135	10	170	5010	5,5
	2600	2150	260	465	410	885	4220	2230	2950	200	135	10	170	6430	7,5
B100	3100	2600	260	465	410	905	4670	2230	2950	200	135	10	180	6780	7,5
	3100	2600	260	465	410	940	4690	2340	2980	210	130	10	180	7750	11
B135	3700	3200	260	465	410	955	5290	2340	2995	210	130	10	180	9400	11
	4100	3600	260	465	410	955	5590	2440	2990	210	130	10	180	10000	11
	3100	2600	260	465	410	955	4700	2430	2975	180	130	10	180	8850	15
B175	3700	3200	260	465	410	955	5300	2430	2990	180	130	10	180	10500	15
	4100	3600	260	465	410	955	5600	2530	2980	180	130	10	180	11050	15
	3100	2600	260	465	410	955	4720	2430	2998	180	140	10	290	10400	18,5
B220	3700	3200	260	465	410	970	5320	2430	3045	180	140	10	290	11950	18,5
	4100	3600	260	465	410	970	5620	2530	3035	180	140	10	290	12750	18,5
	3100	2600	260	465	410	960	4840	2500	3040	150	120	10	290	12300	22
B270	3700	3200	260	465	410	960	5440	2500	3040	150	120	10	290	13500	22
	4100	3600	260	465	410	960	5640	2500	3040	150	120	10	290	14300	22
	3100	2600	260	485	410	955	4860	2490	3080	150	110	10	290	13700	22
B320	3700	3200	260	485	410	955	5460	2490	3085	150	110	10	290	14500	22
	4100	3600	260	485	410	955	5660	2490	3085	150	110	10	290	15300	22
	5100	4200	260	485	410	1030	6660	2570	3210	150	110	10	290	20500	22
	6100	5100	260	485	410	1060	7560	2570	3440	150	110	10	290	25000	22

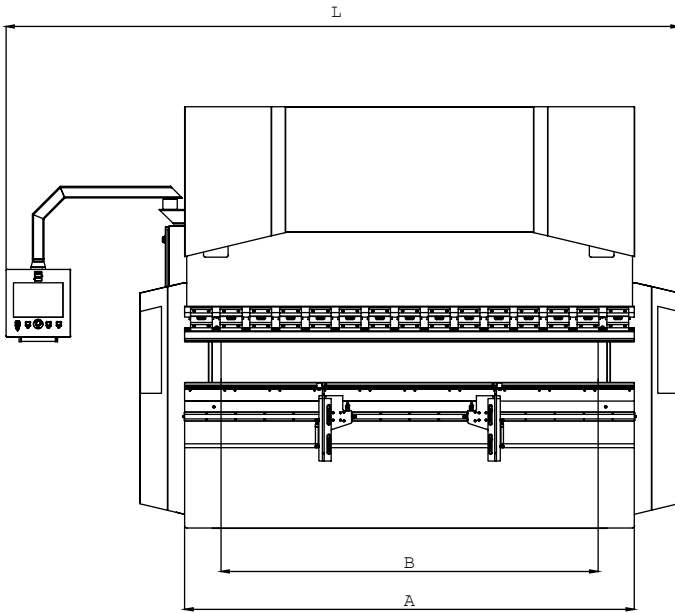
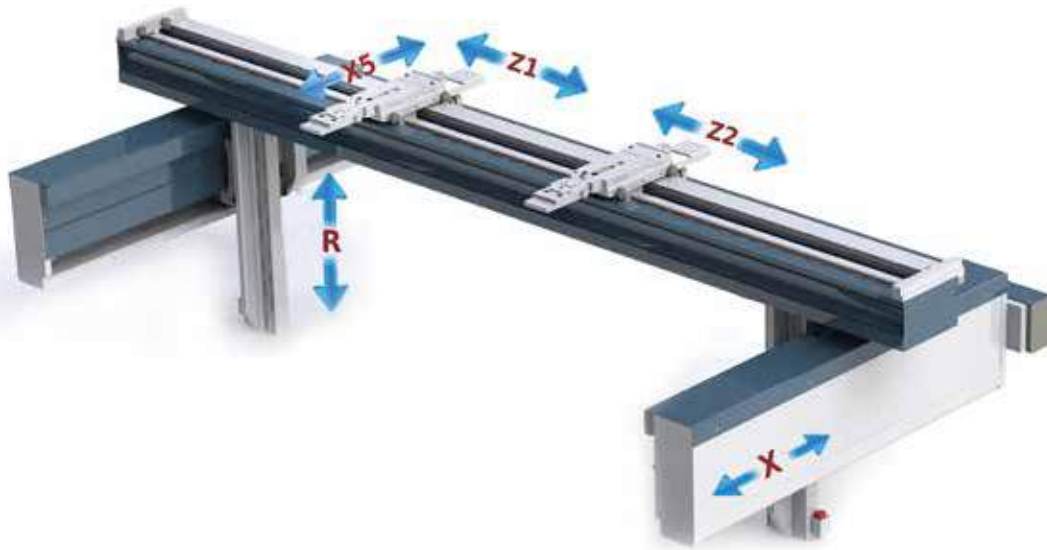

Front view

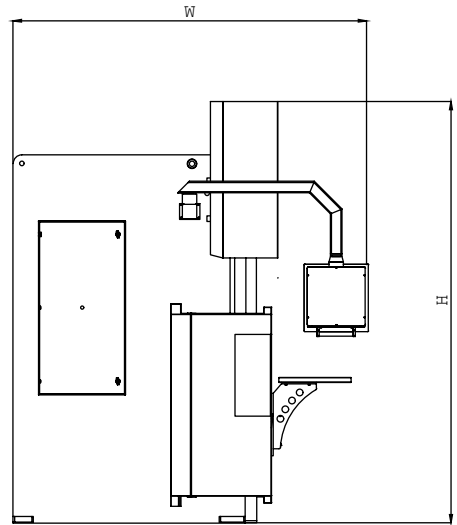

Side view

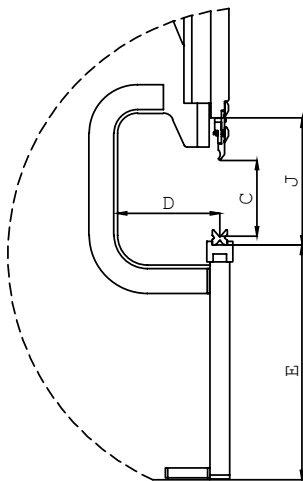

Work zone detail

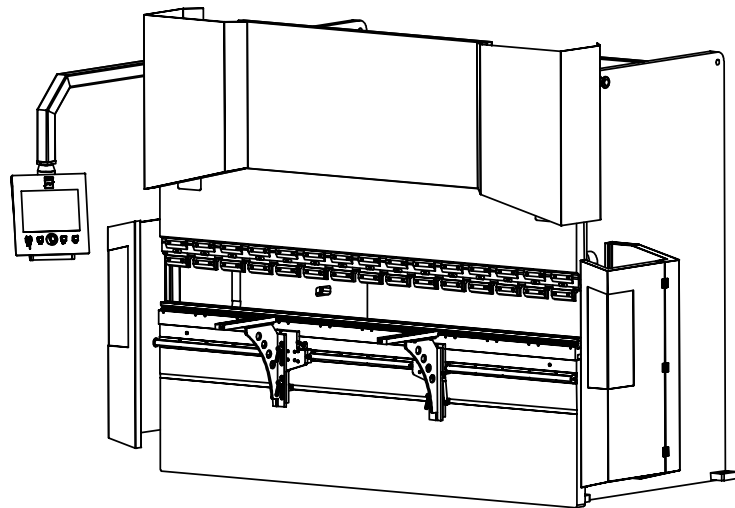

Perspective view